

British Standard 3 Star Anti Snap Euro Profile Cylinder



Features

- High performance euro profile locking cylinder guaranteed for ease of application and long term trouble free performance
- Designed with 6 pin 'bumping' resistance security, the anti pick, anti plug and anti drill features means the cylinder offers excellent resistance to forced entry
- If attacked, a security pin automatically triggers blocking the cylinder cam preventing unlawful entry. The cylinder can still be operated from the inside with a key
- Meets the requirements of PAS 024 as part of a compliant doorset
- Approved by Sold Secure Diamond
- Independently tested to meet the latest British Standards BS EN 1303:2005 for security and awarded a BS Kitemark
- Dual colour cylinder with brass keyhole
- 6 trap pins for enhanced pick resistance
- 12 hardened pins for drill resistance
- 80,000 differs
- Available in Single, Double, Thumbturn and Keyed Alike options
- Each cylinder is supplied with 3 keys



Classification

The Fortress 3 Star cylinder has been approved to BS EN 1303:2005 and carries the following classification:

Category	1	2	3	4	5	6	7	8
Classification	1	6	0	0	0	C	6	2

British Standard 3 Star Anti Snap Euro Profile Cylinder

Ordering Details

Single

Dimensions			Finish	Part No.
A	B	C		
37.5	10	47.5	Dual	BS-FOR-3510-DC-1K
41.5	10	51.5	Dual	BS-FOR-4010-DC-1K
45	10	55	Dual	BS-FOR-4510-DC-1K
50	10	60	Dual	BS-FOR-5010-DC-1K
55	10	65	Dual	BS-FOR-5510-DC-1K
60	10	70	Dual	BS-FOR-6010-DC-1K

Double

Dimensions			Finish	Part No.
A	B	C		
37.5	37.5	75	Dual	BS-FOR-3535-DC-1K
37.5	37.5	75	Dual	BS-FOR-3535-DC-TP2K
37.5	41.5	79	Dual	BS-FOR-3540-DC-1K
37.5	45	82.5	Dual	BS-FOR-3545-DC-1K
41.5	41.5	83	Dual	BS-FOR-4040-DC-1K
41.5	41.5	83	Dual	BS-FOR-4040-DC-TP2K
41.5	45	86.5	Dual	BS-FOR-4045-DC-1K
41.5	45	86.5	Dual	BS-FOR-4045-DC-TP2K
41.5	50	91.5	Dual	BS-FOR-4050-DC-1K
41.5	55	96.5	Dual	BS-FOR-4055-DC-1K
41.5	55	96.5	Dual	BS-FOR-4055-DC-TP2K
41.5	60	101.5	Dual	BS-FOR-4060-DC-1K
45	45	90	Dual	BS-FOR-4545-DC-1K
45	45	90	Dual	BS-FOR-4545-DC-TP2K
45	50	95	Dual	BS-FOR-4550-DC-1K
45	50	95	Dual	BS-FOR-4550-DC-TP2K
45	55	100	Dual	BS-FOR-4555-DC-1K
45	55	100	Dual	BS-FOR-4555-DC-TP2K
50	50	100	Dual	BS-FOR-5050-DC-1K
50	50	100	Dual	BS-FOR-5050-DC-TP2K

Double Thumbturn

Dimensions			Finish	Part No.
A	B	C		
37.5	37.5	75	Dual	BS-FOR-T3535-DC-1K
37.5	37.5	75	Dual	BS-FOR-T3535-DC-TP2K
37.5	41.5	79	Dual	BS-FOR-T3540-DC-1K
37.5	45	82.5	Dual	BS-FOR-T3545-DC-1K
41.5	41.5	83	Dual	BS-FOR-T4040-DC-1K
41.5	45	86.5	Dual	BS-FOR-T4045-DC-1K
41.5	50	91.5	Dual	BS-FOR-T4050-DC-1K
41.5	55	96.5	Dual	BS-FOR-T4055-DC-1K
45	45	90	Dual	BS-FOR-T4545-DC-1K
45	45	90	Dual	BS-FOR-T4545-DC-TP2K
45	50	95	Dual	BS-FOR-T4550-DC-1K
45	50	95	Dual	BS-FOR-T4550-DC-TP2K
50	45	95	Dual	BS-FOR-T5045-DC-1K
50	45	95	Dual	BS-FOR-T5045-DC-TP2K
50	50	100	Dual	BS-FOR-T5050-DC-1K
50	50	100	Dual	BS-FOR-T5050-DC-TP2K
55	45	100	Dual	BS-FOR-T5545-DC-1K

Key Blank

BS 3* Fortress Cylinder Key Blank	BS-FOR-KEYBLANK-K
-----------------------------------	-------------------

Fortress 3 Star BS Single Euro Profile Cylinder

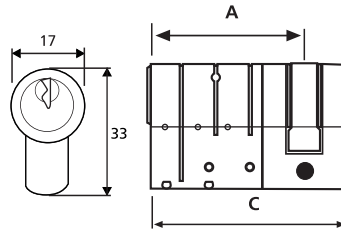

Fortress 3 Star BS Double Euro Profile Cylinder

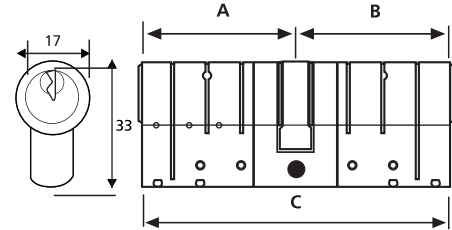

Fortress 3 Star BS Double Euro Profile Thumbturn Cylinder

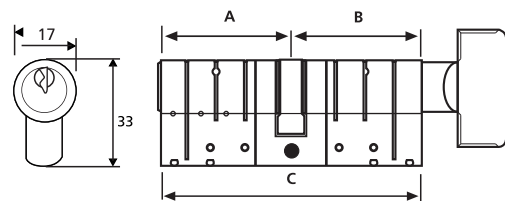

All dimensions are in mm and are nominal.

ERA reserves the right to change specification without notice.
It is the responsibility of the door manufacturer to ensure that the finished product meets any required safety and performance specification.

Maintenance

Wipe the surface periodically with a soft cloth to remove excess grease or moisture.

Packaging

Fortress 3 Star Cylinder

1 cylinder per box, 10 per outer box

Technical Information

Corrosion resistance

Meets the requirements of BS EN 1670:2007 Grade 3

Operation

Endurance tested in excess of 100,000 cycles

Performance (Excluding Thumbturn)

Independently tested to meet the requirements of BS EN 1303:2005 and accredited to TS007 3*. BSI Kitemark License No. 553031. Designed to meet the requirements of PAS 24 in a compliant door set.
30 minute fire test to BS 476: Part 20/22: 1987

Material Specification

Cylinder:	Brass
Cam:	Sintered Steel
Pins:	2 hardened pins, anti bump anti pick and anti-drill
Key:	Nickel plated brass
Screw:	M5 x 45mm and M5 x 70mm nickel plated screws
Finish:	Satin nickel plated brass with brass keyhole